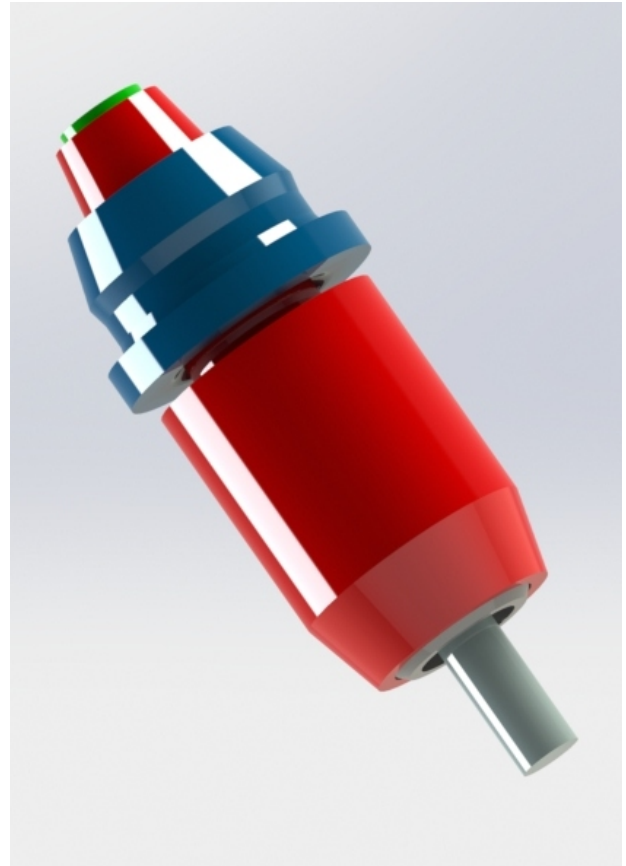

4007H

1. Functional characteristics

- 360 degree opening
- Reference flow rates at 20 and 60 cm H₂O: 34 ml/min, 100 ml/min

2. Recommended Uses

- Layer, Quails, Broilers, Pullets



3. Product description

(a) Drinker composed by 7 elements:

- Plasting body valve with push-in fit for 9.6mm holes
- Inox Plot
- Inox Stem
- Plastic internal sleeve
- Inox internal seal ring
- Rubber seal
- Inox plot retainer

(b) Weight: 8grams

(c) Supplied in trays.

4. Ratings

Water flow for 4007H +- 15%

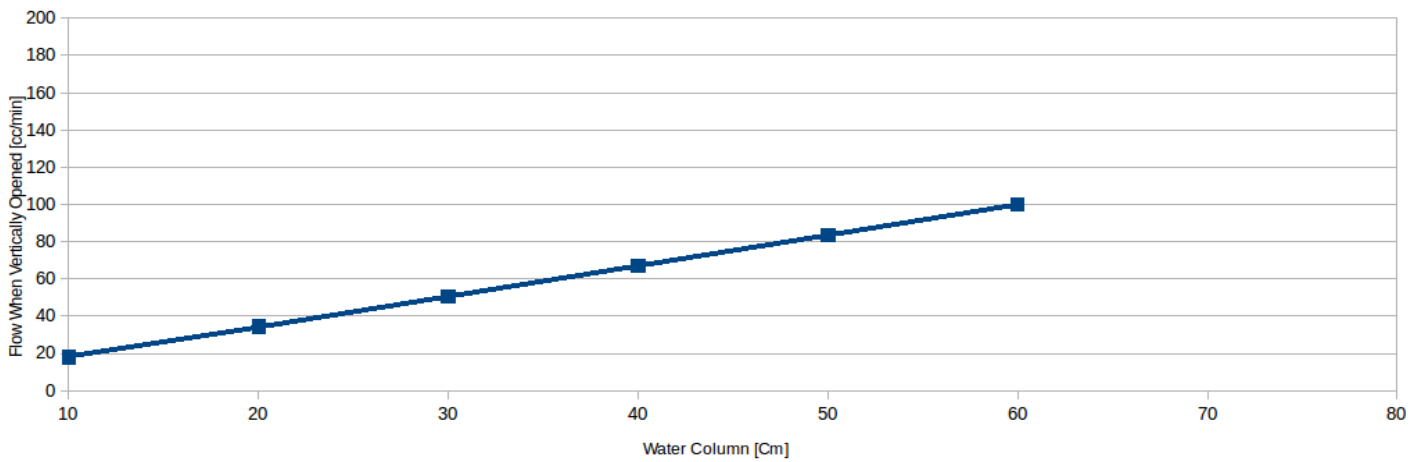

Opening forces for 4007H +- 15%

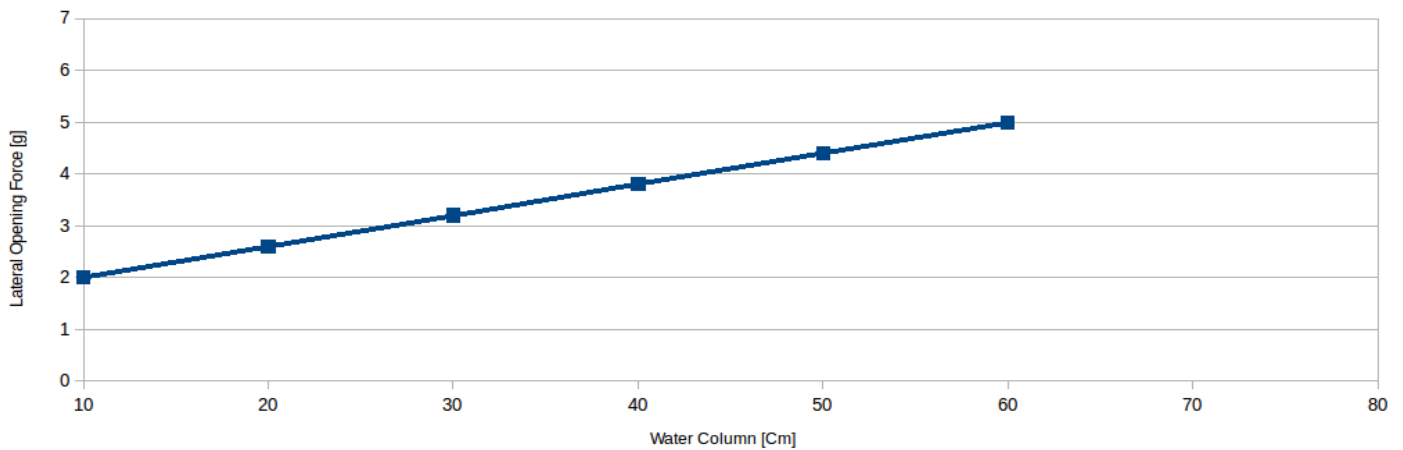

5. Product Revisions:

Document first created : 2017/04/28

DISCLAIMER:

Information contained in this document represents average properties obtained from commercial production lots and should not be considered guaranteed specifications..