



CORTI ZOOTECNICI

# Articles & Accessories for **Breeding**



MADE IN ITALY

# PRODUCT CATALOGUE

📷 corti\_zootechnici    in Corti Zootechnici  
[www.cortizootechnici.it](http://www.cortizootechnici.it)



Use a **QR code reader** on your device to access our website.

Instagram: [corti\\_zootechnici](#) LinkedIn: [Corti Zootechnici](#)  
[www.cortizootechnici.it](http://www.cortizootechnici.it)





## Articles and Accessories for **Breeding**



### **INTERNATIONAL PRESENCE**

We produce and export our high-quality products all over the world.



### **COMPLETE SOLUTIONS**

Specialists in the supply of complete drinking and feeding systems for both large-scale and family farms.



### **ZERO KM PRODUCTION**

We design, engineer and manufacture all our products at our headquarters, controlling the entire production cycle.

MADE IN ITALY



# Main contacts

**GIOVANNI PASOTTO**

Sales office manager

✉ [g.pasotto@cortizootechnici.it](mailto:g.pasotto@cortizootechnici.it)

☎ 0332799985 - IN. 46

**PIETRO ELIA**

Sales office

✉ [p.elia@cortizootechnici.it](mailto:p.elia@cortizootechnici.it)

☎ 0332799985 - IN. 28

**MASSIMILIANO CALORI**

Technical office manager

✉ [m.calori@cortizootechnici.it](mailto:m.calori@cortizootechnici.it)

☎ 0332799985 - IN. 47

## Contact

✉ [info@cortizootechnici.com](mailto:info@cortizootechnici.com)

☎ + 39 0332 799985

🌐 [www.cortizootechnici.it](http://www.cortizootechnici.it)

🏠 St. A. Volta 4, Monvalle 21020 (VA) Italy

## Social

in Corti Zootechnici

📷 corti\_zootechnici

📺 @Corti Zootechnici

f Corti Zootechnici Srl



Use a QR **code reader**  
on your device to access  
our website.





# DRINKING

**Our drinking systems are the result of long experience. They are designed to give the operator all the advantages of robustness and functionality.**

**Our technology allows us to have the softest drinker (less than 1gr opening effort), perfect water delivery, durability, quality, high flow rate (more than 200cc/min) without the need for drip collectors, we also present the new bypass system for pressure line flushing.**

**Discover our wide range of watering products.**



## DRINKING SYSTEMS - FLOOR

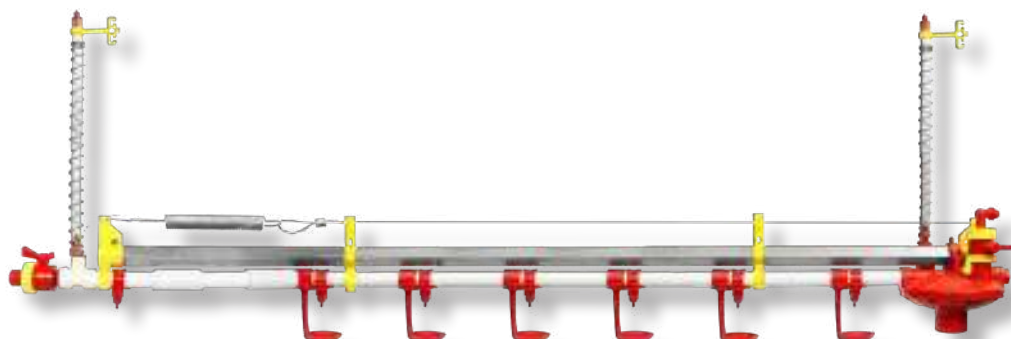

Drinking line with round pipe (ø 26.6 mm)

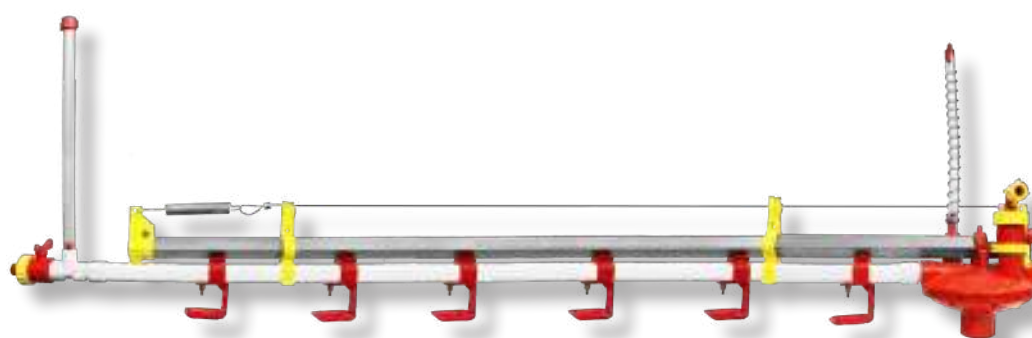

Drinking line with square pipe 22x22 mm

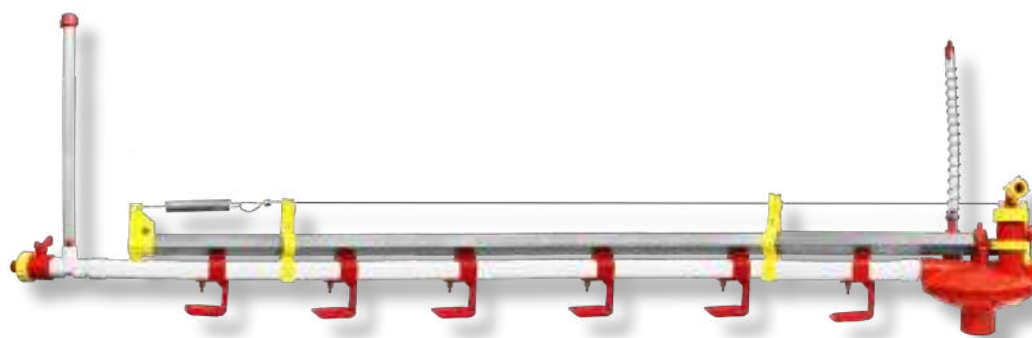

Drinking line with square pipe 28x28 mm

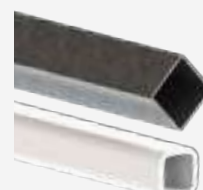



**4733T**

Slide connector for round pipe  $\varnothing 26,6\text{mm}$

**4736 T**

Roud pipe, PVC  $\varnothing 26,6\text{mm}$  holed



**4368**

Slide connector for square pipe

**4101**

Square pipe 22x22mm



**4990V**

Aluminium V-shaped support bar for round and square pipe

**4732V**

Galvanised connector for aluminium V-profile



**47353000**

Galvanised profile 25x25mm

**4732L**

Sheet metal connector for galvanised pipe



**47363000**

Galvanised round support pipe L=3mt  $\varnothing 25\text{mm}$



**4870**

End-of-line kit for round pipe spring height: 900mm,  $\varnothing 9\text{mm}$



**4854**

End-of-line kit for round pipe spring height: 900mm,  $\varnothing 9\text{mm}$



**4870N**

End-of-line kit for round pipe spring height: 500mm,  $\varnothing 12\text{mm}$



**4957N** End-of-line kit fo square pipe h: 500mm,  $\varnothing 12\text{mm}$

**4957F** Flushing version with art.4773 P

N°	Article code	Description
1	4728A	Cristal Pipe 12 L500mm
2	4727A	Sphere $\varnothing 9\text{mm}$ float
3	4849A	Vent valve
4	4726A	Spring D3 450 mm
5	4826A	Cristal pipe support on rope
6	4738	Bush cable clamp
7	4739	Spring T-Df2-De16-L137
8	4742TFLT	Anti roost cable F
9	4751	Rondella flat 6M
10	4781V	Tap PL.3/4" with rubber holder $\varnothing 20\text{mm}$
11	900614	Nut M6
12	4729A	Fitting with hose holder $\varnothing 12\text{mm}$
13	4750A	Elastic vent band $\varnothing 12\text{mm}$

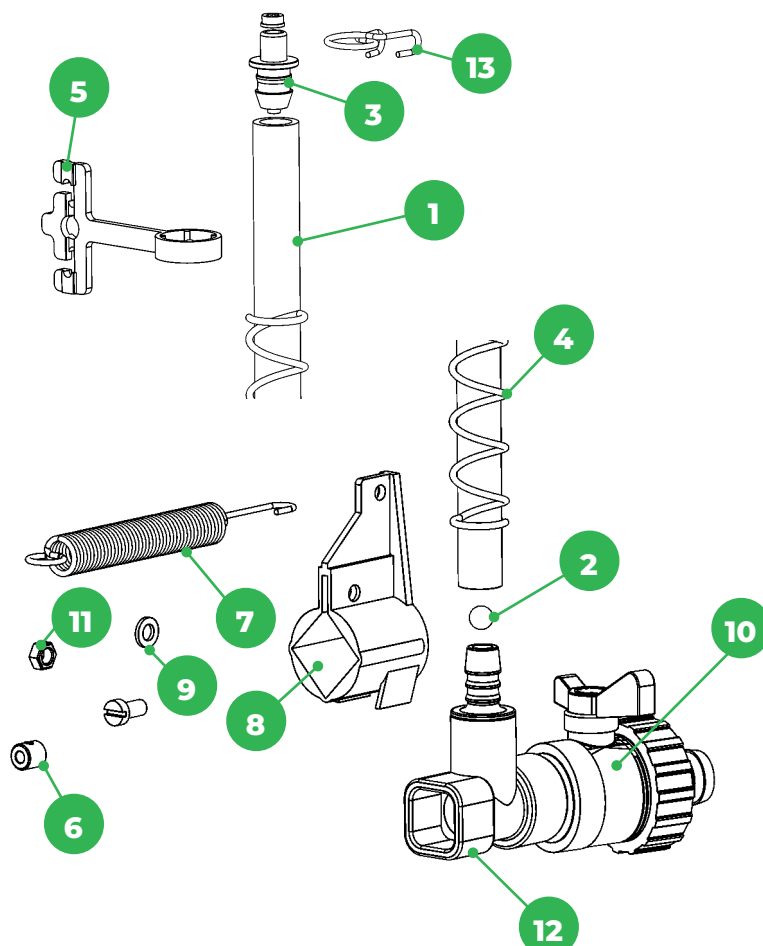



## LIFTING SYSTEMS

600 KG



Capacity  
600 Kg



Colour  
Verde



Actuating force  
15 Kgf



Pulley diameter  
50,8 mm

4422F

**Exclusive friction lock:**

The crank automatically brakes when it is released, when pulling, suspending or releasing loads.



Charging reel  
12,5 m



Product weight  
3 Kg

1350 KG



Capacity  
1350 Kg



Colour  
Verde



Actuating force  
7,1 Kgf



Pulley diameter  
50 mm

4436

Screw winch H-3600 suitable for the suspension of automatic supply lines.



Charging reel  
10,5 m



Product weight  
9,8 Kg

900 KG



Capacity  
900 Kg



Colour  
Argento



Actuating force  
12 Kgf



Pulley diameter  
54 mm

4424F

To be mounted on the wall at the head of the shed

**Exclusive friction lock:**

The crank automatically brakes when released, when pulling, suspending or releasing loads.



Charging reel  
19 m



Product weight  
5,5 Kg

907 KG



Capacity  
907 Kg



Colour  
Rosso



Actuating force  
12Kgf



Pulley diameter  
51 mm

4425

Winch for supply and drinking lines, preferably to be mounted on the ceiling in the middle of the shed, so as to halve the load on the cable



Product weight  
10,7 Kg

1200 KG



4433E

Electric winch



Capacity  
150/300 Kg



Colour  
Red



Product weight  
11,6 Kg

4434E

Electric winch



Capacity  
300/600 Kg



Colour  
Red



Product weight  
16,8 Kg





**4719**  
Plastic pulley  
ø60mm max. load  
capacity 40kg



**4719H**  
Nylon pulley  
ø60mm max. load  
capacity 70kg



**4719P**  
Plastic pulley  
ø22mm max. load  
capacity 30kg



**4713**  
Pulley ø 90 mm



**1601**  
Pulley ø 90 mm with  
coupling



**4716**  
Galvanised cable  
clamp ø 5 mm



**4738**  
Steel sleeve clamp



**4747**  
Cable clamp with  
washer for steel  
cable



**4746**  
Plastic screw  
clamp



Galvanised steel  
cable  
**4714** ø5mm, 133 threads  
**4737** ø1,6mm, 19 threads  
**4715** ø4mm, 19 threads



**4718**  
White polyester  
rope ø3,2mm  
**4478**  
Polyester cable  
orange ø6mm



**4767**  
Two-hole tensio-  
ning plate

## Kit



### 4480

Central ceiling hoisting kit, consisting of winch, anchor plate, threaded bar, two nylon pulleys ø60mm. Can be used for drinking and supply lines.

- 4415 Winch i. screw H-2000 mm
- 4426 Plate for winch fixing H-2000 mm
- 4428 Galvanised screw 8X35 mm
- 4704 Washer ø 8 mm
- 4705 Galvanised threaded rod 333 mm
- 4706 Zinc nuts
- 4707 Galvanised washer ø 8 mm
- 4719H Pulley ø 60 mm

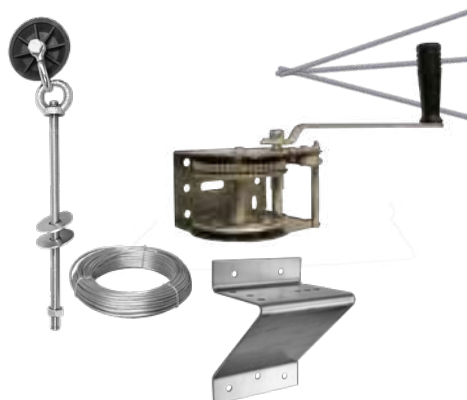

### 4860F

Feed line lifting kit. With the use of winches and pulleys, quick lifting of the lines is ensured, allowing easy access to the farm area during maintenance and cleaning operations. The cable can be positioned to work in any direction, thanks to the special design of the ø90 mm sheave.

- 4422F 600 kg winch with clutch
  - 470201 Galvanised washer 8.4x16x1.6 mm
  - 4703 Screw ø 8 mm galvanised
  - 4704 Washer ø 8 mm
  - 4705 Galvanised threaded rod 333mmø8 mm
  - 4708 Galvanised threaded rod 333mmø14 mm
- ... contact us to see the complete list



### 4481

Central ceiling hoisting kit, consisting of winch H3006, anchor plate, threaded bar, two nylon pulleys ø60mm. Can be used for drinking and supply lines.

- 4428 Galvanised screw 8X35 mm
- 4436 Screw winch 1350 kg
- 4704 Washer ø 8 mm
- 4705 Galvanised threaded rod 333 mm ø8 mm
- 4706 Zinc nuts
- 4707 Galvanised washer ø 8 mm
- 4719H Pulley ø 60 mm



### 4427

Crank handle for line adjustment via lifting kit  
art. 4480/ 4481



Kit

**4862**

Pulley  $\varnothing 90$ mm, with fixing kit, ideal for wall mounting in drinking line lifting kits



Kit

**4426**

Mounting plate kit for winch 4425

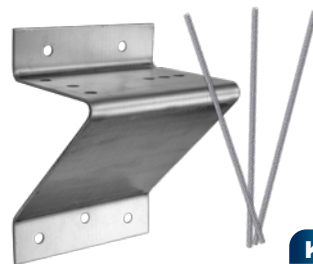

Kit

**4861**

Mounting Plate Kit for winch 4422-4424F



**4711**

Galvan. eyebolt  $\varnothing 14$  mm

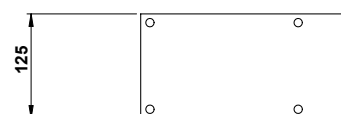
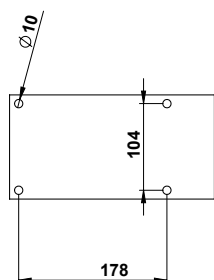

**4712**

Galvan. clevis  $\varnothing 12$  mm

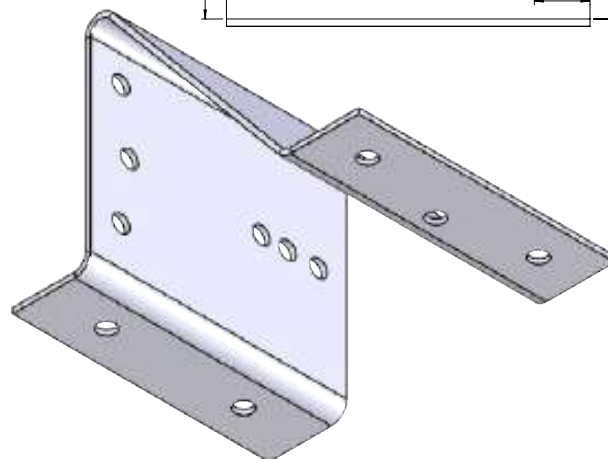
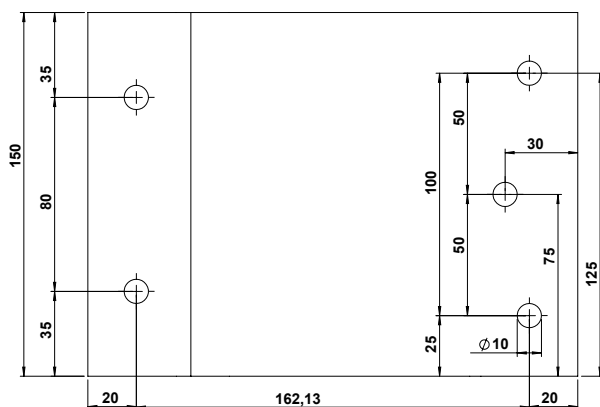
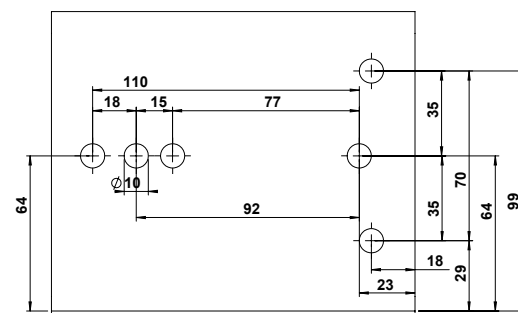
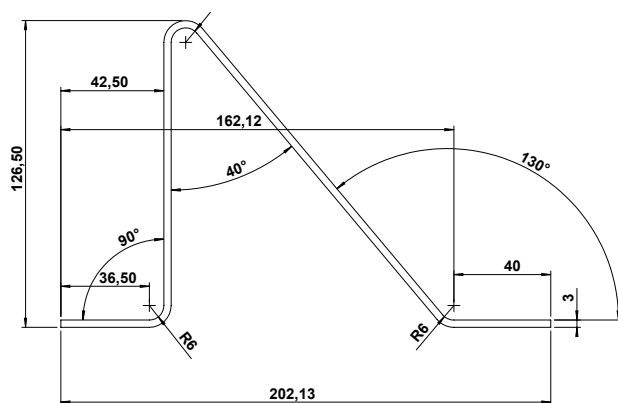
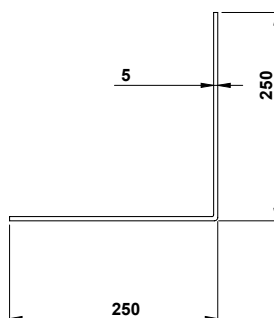

## DRIP CUP



Wide range of choices, sizes, heights, widths available to meet the needs of each animal.



The trays are designed to keep the litter dry.



Provides indications of the pressure level of the drinking line.

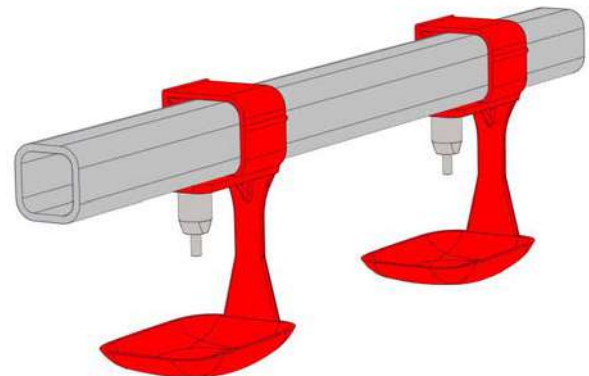

### 4613CC

Drip cup for 22x22 mm square pipe, grey version: 4613CCG

### 4613CCN

grey version: 4613CCG

### 4613TQ

Drip cup 22x22 mm square pipe for SNAP

### 4613ZN

Drip cup for 22x22 mm square pipe

### 4613N

Drip cup for 22x22 mm square pipe, yellow version: 4613NG



### 4613 TV

Drip cup for round pipe ø22 mm

### 4613 TT

Drip cup for round pipe ø 26,6 mm for SNAP

### 4613BCC

Drip cap for square pipe, 28x28mm

### 4613B

Drip cap for square pipe, 28x28 mm, grey version: 4613BG

### 4613Z

Drip cup for square pipe 22x22 mm, yellow version: 4613ZG grey version 4613ZC



### 4640

Drip cup



### 4616

Drip cup



### 4606

Drip collection channel 120° - length on request

### 4609

Drip collection channel 90° - length on request



# 360° DRINKERS

Corti Zootecnici's Drinkers



UV and chemical  
**resistance**



High-**strength**, high-  
**quality** materials



**Excellent sealing**,  
zero water waste and  
dry litter



## DRINKERS LINE - SYSTEM 360°



The lightness of the 360° drive facilitates drinking for the animals by ensuring that the water flow rate is delivered directly to the nozzle in proportion to each animal's needs, avoiding splashing and wastage.

### 4002HS



#### Functional Features

Reference flow rates at 20 and 60 cm H2O column: 65 cc/min, 160 cc/min

Square pipe 22x22 and 28x28



### 4002H



#### Functional Features

Reference flow rates at 20 and 60 cm H2O column: 60 cc/min, 160 cc/min

#### Recommended uses

Dirt cup optional

4002HL Turned version



### 4002HH



#### Functional Features

Reference flow rates at 20 and 60 cm H2O column: 65 cc/min, 180 cc/min

#### Recommended uses

With drip cup



### 4004



#### Functional Features

Reference flow rates at 20 and 60 cm H2O column: 40 cc/min, 100 cc/min

#### Recommended uses

With drip cup - A terra



### 4006H



#### Functional Features

Reference flow rates at 20 and 60 cm H2O column: 50 cc/min, 140 cc/min

#### Recommended uses

With drip cup



### 4006HH



#### Functional Features

Reference flow rates at 20 and 60 cm H2O column: 80 cc/min, 190 cc/min

#### Recommended uses

With drip cup

4006HHL Turned version



### 4006I



#### Functional Features

Reference flow rates at 20 and 60 cm H2O column: 70 cc/min, 160 cc/min

#### Recommended uses

With drip cup

4006ILL Turned version



### 4007H



#### Functional Features

Reference flow rates at 20 and 60 cm H2O column: 34 cc/min, 100 cc/min



### 4007HH



#### Functional Features

Reference flow rates at 20 and 60 cm H2O column: 34 cc/min, 100 cc/min



### 4011HH



#### Functional Features

Reference flow rates at 20 and 60 cm H2O column: 46 cc/min, 126 cc/min



### 4002R



#### Functional Features

Reference flow rates at 20 and 60 cm H2O column: 28 cc/min, 100 cc/min

#### Recommended uses

Dirt cup optional



## VERTICAL SYSTEM DRINKER LINE



Corti Zootecnici's vertical action drinkers are specially designed to be adapted to laying and breeding farms.

The care used in production and the composition of the stainless steel parts make the vertical drinkers more resistant to wear and tear in order to guarantee an unlimited service life.

The design of the individual internal components of the trough guarantees an optimal water supply.

**4001**

### Functional Features

Reference flow rates at 20 and 60 cm H<sub>2</sub>O column: 40 cc/min, 100 cc/min

### Recommended uses

With drip cup or drip collection channel



**4003**

### Functional Features

Reference flow rates at 20 and 60 cm H<sub>2</sub>O column: 40 cc/min, 100 cc/min

### Recommended uses

With drip cup



**4005R**

### Functional Features

Reference flow rates at 20 and 60 cm H<sub>2</sub>O column: 77 cc/min, 180 cc/min

### Recommended uses

With drip cup



## CONSTANT LEVEL DRINKERS WITH DRIP CUP



**4260R**

Acquapresente ST weaning drinker for square pipe 22 x 22 cm



**4020**

Chick drinker with extension, SP, quick release



**4019R**

Chick drinker with extension, SP, quick release



**4250R**

Drinker circular cup, SP, quick release



**4618**

Laying and poultry cup, to combine with art. 4005 R



**4619**

Chick cup, to combine with art. 4005 R



## SNAP DRINKERS

The 360° actuation facilitates drinking for the animals by ensuring that the water flow rate is delivered directly to the beak in proportion to each animal's needs, avoiding waste.

Through the quick clip system, SNAP drinkers have the possibility of being attached to the feed lines directly on the rigid PVC pipes by means of the practical round or square tie without the use of glue products.

Also available without tie.

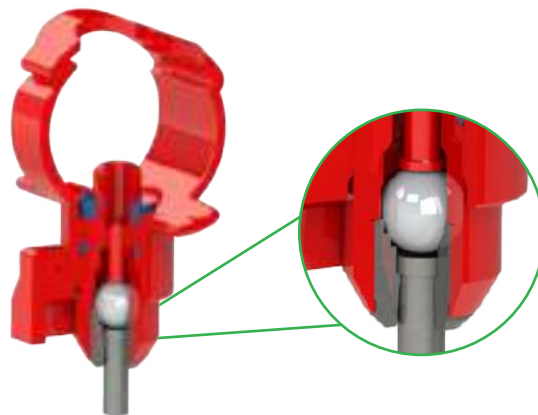
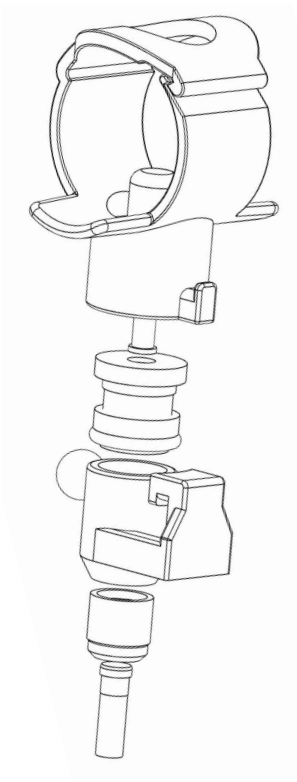

-  Resistant
-  No waste
-  No splashes
-  Facilitates drinking



**4731**

Super flow snap drinker, coarse lower part, connection for round pipe  $\varnothing 26,6$  mm



**4731G**

Snap drinker, coarse lower part, connection for round tube  $\varnothing 26,6$ mm



**4731SV**

Snap drinker 4002H on snap body coarse bottom part attachment for round pipe  $\varnothing 26,6$ mm



**4731H**

Snap drinker 4004H on snap body lower part small round pipe connection  $\varnothing 26,6$ mm



**4731HH**

Snap drinker on snap body, small bottom part, attachment for round pipe  $\varnothing 26.6$  mm



**4731BHH**

Snap drinker on snap body, small bottom part, attachment for round pipe  $\varnothing 26.6$  mm

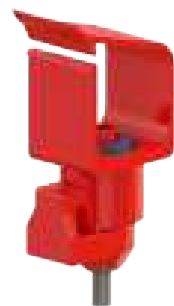

**4731AQ**

Snap drinker, coarse lower part, 22x22 mm round pipe connection



**4734**

Safety clip for locking snap drinker

## TAPS

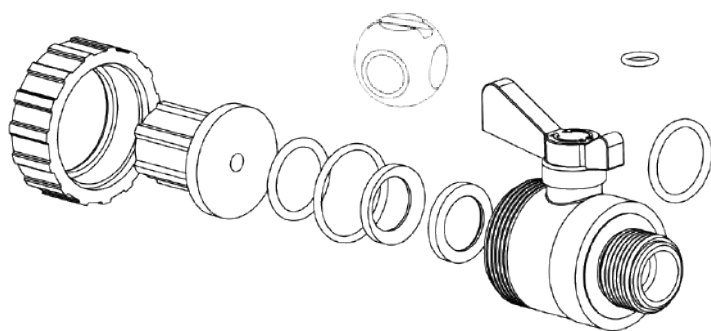

- Studied down to the smallest detail;
- Wide range of selection;
- High quality;
- Durable materials;
- Long-lasting.



**4778**

Ball tap 3/4" with 90° exit for pipe ø 12 x17 mm with ring nut



**4778Q**

Ball tap 3/4" for pipe ø12x15mm with ring nut

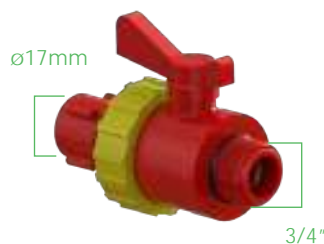

**4778D**

Ball tap 3/4" for tube ø 12x17mm with ring nut



**4781**

3/4" ball tap cristal

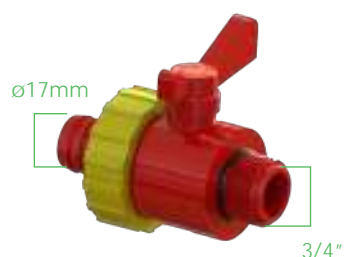

**4781V**

Tap 3/4" M with hose connector ø22mm



**4783**

3/4" ball tap with 90° outlet, crystal control fitting

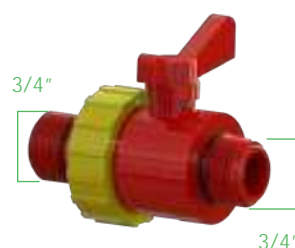

**4784**

Ball tap 3/4" M aplug 3/4" M



**4785**

Ball tap 3/4" M with round pipe fitting ø26.6mm



**4779**

Ball tap with bypass for regulator available for 15 mm and 17 mm hose, straight or L-shaped outlet



**4771L**

Connection ø1/2" for corner tap



**4771T**

T-connection flex tube or spiral øint12.5x15mm



**4771V45**

Tap shank with 45° rubber connection



**4773Q**

Yellow ring nut for pipe ø12.5x15mm



**4773D**

Yellow ring nut for pipe ø12.5x17mm



**4771C**

Straight connection for tube tap

## ANTI ROOST SYSTEM



**4742**

Support for 22x22mm square PVC pipe and 25x25mm or ø26.6mm RP



**4742T**

Support for round PVC pipe ø26.6mm and 25x25mm or ø26.6mm RP



**4742T2**

Support for round PVC pipe ø26.6mm and 25x25mm or ø26.6mm RP



**4742TQA**

Support for 28x28 mm square PVC pipe



**4742TQ**

Support for 22x22mm and ø25 mm square pipe



**4742TT**

Support for round pipe ø25 mm and ø26,6 mm



**4742QT**

Support for 25x25 mm tube, ø26,6 mm



**4742QQ**

Support for 25x25 mm, 22x22 mm



**4950**

Semi-support for V-profile



**474202**

Extension for double anti-roost wire support



**Kit**

**4742V**

Start/end of line kit: two anti-roost supports and a clip for attaching the pressure regulator to the aluminium V-profile



**4742TFTQ**

Support for galvanised ø 25 mm square pipe



**4742TFQT**

Support for ø 25mm galvanised pipe



**4742TFTT**

Support for round pipe ø 25 mm galvanised and tube ø26,6 mm



**4742TFL**

Support for galvanised support bar and pipe ø26,6 mm



**4742TFLT**

Support for galvanised bar and square PVC pipe



**4742TFLQ**

Support for galvanised bar and square PVC pipe



## ACCESSORIES FOR DRINKING SYSTEM



**4726** Support for cristal pipe  
L: 65 cm  
**4727** Floating ball  $\varnothing$  6.35 mm for level control  
**4728** Flex cristal pipe  
9x12x900mm  
**4849** Vent valve for cristal pipe



**4726A** Support for cristal pipe  
L: 45 cm  
**4727A** Floating ball  $\varnothing$  9mm for level control  
**4728A** Flex cristal pipe  
12x17x500mm  
**4849A** Vent valve for cristal pipe

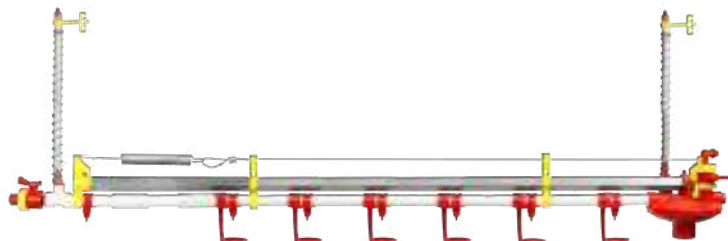

**4739**  
Regulator cable tensioning spring



**4827**  
Rilsan spiral coupling



**4948**  
Support for aluminium profile V



**4946**  
Aluminium V-profile clamp



**4947**  
Aluminium V-profile clamp for square PVC pipe



**4947P**  
Aluminium profile square pipe clamp



**4945L**  
Aluminium V-profile clamp for square PVC pipe



**4947C**  
Aluminium V-profile clamp for square PVC pipe



**480108**  
3/4" crystal pipe holder



**400ATZ01**  
Key for drinkers  
n°4001-4002-4006I



**400ATZ02**  
Key for drinkers  
n°4006



**400ATZ03**  
Key for drinkers  
n°4005



**4773PR**  
1/2" fitting for rilsan pipe 12.5x17 mm with guard and red ferrule



**4773PG**  
1/2" fitting for rilsan pipe 12.5x15 mm with guard and yellow ring nut



**4773P**  
Screw connector 12.5x15 without ferrule



**4826**  
Support for cristal pipe



**4826A**  
Support for cristal pipe



**4826D**  
Support for cristal pipe

## PRESSURE REGULATORS



**4901**  
Pressure regulator with  
bypass



**4901N**  
Pressure regulator with  
bypass with vent  $\varnothing 12$  mm



**4901NT**  
Regulator with bypass with  
vent  $\varnothing 12$  mm L. 800 mm for  
turkey lines



**4724R**  
Square pipe head  
 $\varnothing 26.6$  mm in bayo-  
net connector +  
gasket



**4725R**  
Square pipe head  
 $\varnothing 26.6$  mm bayonet  
connector for  
gluing



**4363AT26R**  
Bayonet connec-  
tor head 28x28  
mm  $\varnothing 26.6$  mm  
square pipe

**4901B** BY-PASS Pressure Regulator for Cages | **4901BB** BY-PASS Pressure Regulator for Cages | **4903** BY-PASS Pressure Regulator for Cages

### 4864C

Flushing kit applicable on all types of regulators by Corti Zootecnici.

Allows automatic flushing of barrels.



Kit

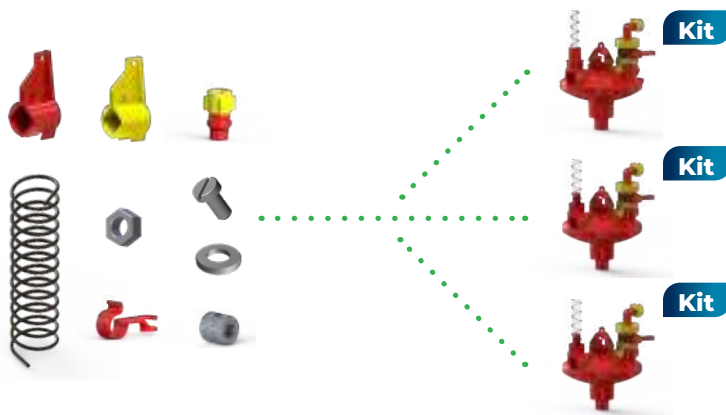

Kit

**4863N**  
Ground drinking system kit (Art. 4901)

**4863D**  
Grounded drinking system kit for  $\varnothing 12$  vent (Art. 4901N)

**4863DT**  
Ground drinking system kit (Art. 4901NT)

## SLOPE CONTROL

**4802N** Slope control with vent  $\varnothing 12$

**4802** Slope control

**4802NT** Slope control with vent  
L:800 mm

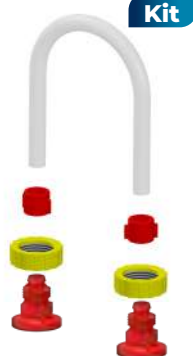

Kit

**4858** Quick flushing kit for slope  
regulator

- **4104 R1/2** Flex pipe 1/2" for water in/out
- **4771C** Straight tap shank for pipe
- **4773D** Red ferrule for pipe  $\varnothing 12,5 \times 17$  mm
- **478410** Yellow adjustment ring for tap

## HYDRAULIC SECTION



**4804E | 4804GE**  
Dispenser of 25-RE5  
adjustable 1%-5%.



**9201**  
Industrial filter with  
cartridge 50 mic.



**9210**  
Self-cleaning filter 3/4"  
mains washer 90mcr



**9211**  
Filter with washable  
polyphosphate  
cartridge + unscrewing  
and screwing pliers



**6302M**  
1/2" fixing collar fitted



**6305 | 6306**  
Plastic feed collar ø 32  
mm threaded  
3/4" | 1/2"

**Kit**



Main water supply panel



**4807CV**  
Litre counters



**4807ICV**  
Electric flowmeter  
with counter  
output



**4815**  
Pressure gauge for  
filter and regulator

**Kit**



**4803M**  
Metal pressure  
reduction kit  
1.5/7bar

**Kit**



**MAGNETIC  
FLOWMETER KIT**

### 4807M35 | 0,05-35 LT./MIN

- 480104 Gasket
- 480702 Fitting for flowmeter
- 4807MIF01 Cable for magnetic flowmeter
- 4807MIF02 Battery charger for digital flowmeter
- 4807MIF03 Flowmeter kit board (2 clean outlets)
- 4807MIF04 Protection box
- 4807MIF35 Magnetic flowmeter 0.05-35 l/min

### 4807M75 | 0,10-75 LT /MIN

- 4807MIF01 Cable for magnetic flowmeter
- 4807MIF02 Battery charger for digital flowmeter
- 4807MIF03 Flowmeter kit board (2 clean outlets)
- 4807MIF04 Protection box
- 4807MIF75 Magnetic flowmeter 0.10-75 l/min



**4804I**  
Peristaltic pump







# FEEDING

Corti Zootecnici has been producing feeders for over forty years to optimise animal growth throughout the life cycle.

Feeding in poultry sheds is essential to ensure the health and growth of the animals. The choice of feeders for poultry sheds is an important element in ensuring efficient and clean feeding, here you will find a wide range of choice, from weaning to fattening.



# INFINITY

Corti Zootecnici's Feeder



Easy adjustment of  
min and max feed  
level



Fast dispensing,  
always fresh feed,  
zero waste



Prevents the animal  
from entering the  
feeder



**4456**

Manual feeder for ground installation  
with automatic lifting kit

**THE FEEDER THAT OPTIMISES THE ANIMAL'S  
GROWTH THROUGHOUT ITS LIFE CYCLE**





**4457**  
Cage feeder with automatic lifting kit



**445509G**  
Anti-waste collar



Kit

- **4455 S**  
Feeding with capacitive sensor
- **445508M**  
Support for capacitive sensor
- **447215**  
Capacitive sensor
- **4459**  
Feeder with cap kit ø 48 mm

- **4459S**  
Feeder with capacitive sensor ø 48 mm
- **445510M**  
Cap kit with marbled anti-roost, ø 48 mm



**4458**  
Manual adjustment rod

## AUTOMATIC FEEDING SYSTEM



**4470**  
UNICA | complete automatic feeder

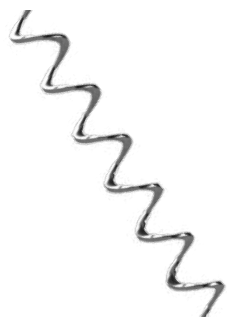

**4476**  
Steel spiral for feeding (4470)



**4474MP/SC**  
Plastic container top of line



**4472M**  
Cap for automatic feeder complete with micro



**48091**  
Electrifier, useful when the animal is standing on the drinking line



**4479**  
Feed auger extraction control microswitch



Kit

**4474SC6**  
Capacitive sensor kit delay 10 sec.

- **447401** Complete black bottom part
- **4474SC03** Plastic counter nut for 2-wire sensor
- **4474SC04** Plastic cable gland for 2-wire sensor
- **4474SC06** Capacitive sensor 2-wire delay 10 sec.



Kit

**4474SC5**  
Capacitive sensor kit 5-wire sensitivity and time setting

- **4474SC01** Micro-hole housing for sensor
- **4474SC501** Capacitive sensor 5-wire



Kit

**4474SC**  
2-wire capacitive sensor kit timed 30 seconds

- **4474SC01** Micro-hole housing for sensor
- **4474SC02** 2-wire capacitive sensor
- **4474SC03** Plastic counter nut for 2-wire sensor
- **4474SC04** Plastic cable gland for 2-wire sensor





- 4473M1 Towing drive MO. 0,75Kw-220V-50/60Hz
- 4473M1SC Towing drive MOT. MONOF 1CV x SC
- 4473M2 Towing drive 1,5CV 230V-50/60Hz
- 4473M2SC Towing drive MOT. MONOF 1,5CV x SC
- 4473T1 Towing drive 3f 0,75Kw 230/400V 50/60Hz
- 4473T1SC Towing drive MOT. TRIFASE 1CV x SC
- 4473T2 Towing drive MOT. TRIF 1,5CV230V/400/50NV
- 4473T3/4 Towing drive MOT. THREE-PHASE 1CV x SC
- 4474 Plastic container with overhang ini x447
- 447401 Only black plastic lower part x4474



- 4477 Galvanised pipe clamping band
- 44753000P600 Pipe Galv. D=45 L=3000 P=600
- 44753000P750 Pipe Galv. D=45 L=3000 P=750
- 44753000P1500T Pipe Galv. D=45 L=3000 P=1500 SP 1,2
- 4476 Steel spiral for feeding 4470

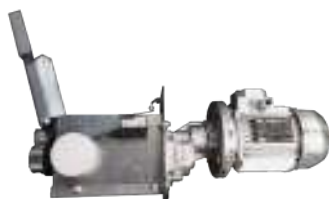

**4473T3/4SC**  
Drive unit with three-phase motor 0.75 KW for capacitive sensor



**4490**  
Assieme supporto canale

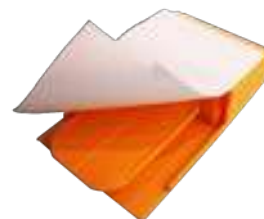

**5184**  
Sensor for supply container 4474

## SISTEMA DI ALIMENTAZIONE PER GABBIE



**4204R**  
Float for intensive rearing. Meets the need for high-pressure water capacity. The ø6mm nozzle allows perfect operation up to a maximum pressure of 5bar



**4205**  
Mini-float for V-gutter; Can also be used in other applications where water regulation is required



**42012UV**  
8 litre tank with float (Art. 4204R). Available in several versions depending on:  
colour | type | size | outlet position

## END OF LINE FOR CAGES AND GROUND SYSTEMS

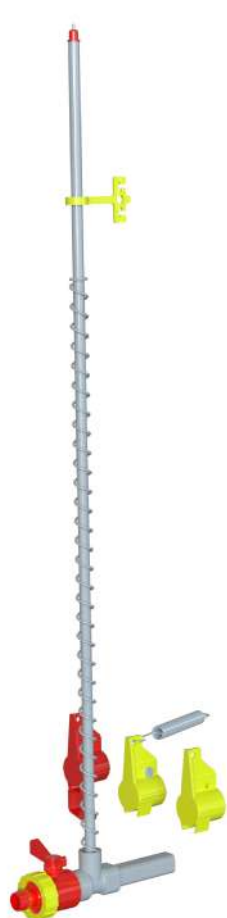

Kit

**4854**  
End-of-line kit S.P.  
tap

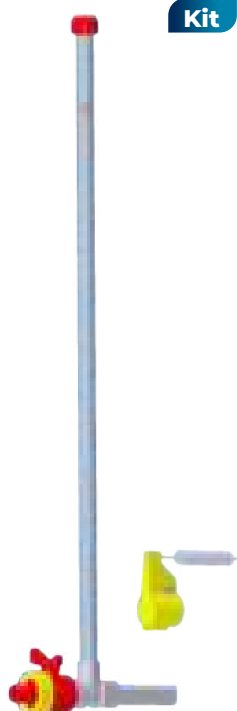

Kit

**4854SE**  
End-of-line kit S.P.  
with rigid venting  
tap



Kit

**4955**  
End-of-line kit  
square pipe

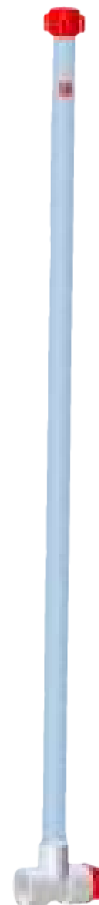

Kit

**4956**  
End-of-line kit  
round pipe.



Kit

**4957N**  
End-of-line kit  
square pipe control  
ø12



**4896-4897-4896L**  
End-of-line cleaning brush  
L: 52,5 cm, ø 9 mm  
L: 89 cm, ø12 mm  
L: 76 cm, ø12 mm

Line 22x22

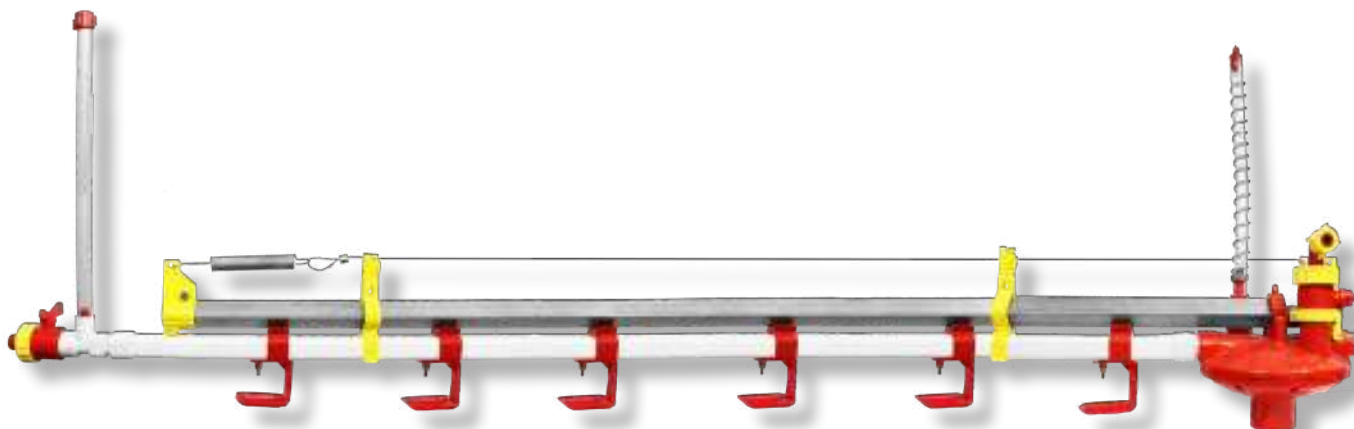

## TURKEY SECTION



**4260R**  
Acquapresente ST weaning  
drinker 22x22cm



**4626 | 4627**  
Drinker for square pipe for  
fattening 2x22cm | 28x28cm



**4742S**  
Support for ground square pipe



**46266**  
Base for turkey square pipe  
support



**4456**  
Infinity weaning feeder



**4440T**  
Automatic turkey feeder



**4440TL**  
Automatic light turkey feeder



**4440TP**  
Automatic heavy turkey feeder



**4440T08**  
Collar for automatic turkey feeder







# PIPES AND FITTINGS

Our pipes are made of high-quality materials that ensure strength and durability. Available in different sizes and thicknesses, our pipes are suitable for a wide range of uses, from industrial to domestic.

Our couplings are designed to ensure solid and reliable connections between pipes. Made with precision and durable materials, our couplings ensure a perfect seal and a long service life.

With our commitment to innovation and quality, you can rely on our catalogue to find the right components for every project.



## FITTINGS, FLEX PIPES



**4791**  
Connection T  $\varnothing 26,6\text{mm}$   
F - 3/4" F - 3/4" F



**4792**  
Angle connection  
 $\varnothing 26,6\text{mm}$  F -  $\varnothing 26,6\text{mm}$  F



**4795**  
Linear connection  
 $\varnothing 26,6\text{mm}$  F - 3/4" F



**4368C**  
R6 square pipe joint for  
gluing



**4323**  
Connection T  $\varnothing 16\text{-}$   
18mm



**4327**  
Cross connector  
 $\varnothing 22\text{mm}$



**4351**  
90° angle fitting  $\varnothing 16\text{-}$   
18mm



**4329V**  
Angle  $\varnothing 25\text{mm}$  for PVC  
pipes



**4321**  
Joint  $\varnothing 22\text{mm}$



**4724**  
End cap  $\varnothing 26,6\text{mm}$   
for square pipe with  
gasket



**4724R**  
Bayonet plug head  $\varnothing$   
26.6 mm square pipe  
with gasket



**4725R**  
Bayonet plug head  $\varnothing$   
26.6 mm square pipe  
with gasket



**4363AT26R**  
Bayonet plug square  
pipe  
28x28 |  $\varnothing 26.6\text{ mm}$



**4363 A**  
S.P. adapter-head  
28x28 mm | 22x22 mm



**4363AT**  
S.P. adapter-head  
28x28 mm |  $\varnothing = 22\text{ mm}$



**4363AT26**  
S.P. adapter-head  
28x28 |  $\varnothing = 26.6$



**437501**  
T-connector for 3/4"  
threaded square pipe



**437601**  
T-piece for end of line  
 $\varnothing 25\text{ mm}$  threaded  
3/4" F



**AI 005**  
Rigid 28x28 pipe joint  
for gluing



**420805N**  
Black rubber outlet  
ø22mm  
**420803N** nut  
**420802** gasket



**4208N**  
Hose outlet ø22mm  
4208 White version



**4214**  
Tank outlet It 8 sect.  
22x22mm



**4378**  
T-connector for fineline  
with hose connector



**4810**  
End of line T-union R.P.  
ø26.6 mm



**4772Q**  
Rilsan spiral pipe  
ø12x15mm - L: 6 mt



**4103** Black flex pipe ø19x25mm  
**4104** Black flex pipe ø12x17mm  
**9101** Black flex pipe ø9x12mm  
**4107** Black flex pipe ø5,7x9,78mm  
**4105** Black flex pipe ø5x8mm



**4108**  
Round pipe øint30mm  
flex frame transparent



**4193**  
Transparent flex pipe  
ø19x24,5mm



**4744**  
3/4" threaded plug  
with gasket



**4797**  
Nipple fitting 3/4 "M  
with gasket



**4798**  
Pipe union for pipe  
ø26.6 mm



**4953FO**  
Upper cap for end of  
line with gasket



**4205P**  
Hose connector with  
quick-release coupling  
1/2F



**4723**  
Angle fitting for tran-  
sparent pipe



**4366 | 4363F**  
Joint ties for pipes  
22x22 | 28x28



**4366V | 4363V**  
Joint ties for pipes  
22x22 | 28x28



**4104R 1/2"**  
Ribbed flex hose (1/2")  
**4104R 3/4"**  
Hose flex hose (3/4")





**MF70111**  
PP T-piece 3/4" - 3/4" F



**MF70311**  
90° pipe in PP 3/4" - 3/4" F



**4314**  
Cap Ø22mm

**4329** Angle connection 90° Ø22mm

**4330** T-connector Ø25-30mm

**4331** T-connector Ø12-14mm

**4733T** Joint for round tube Ø26,6mm

**4786** T Ø26,6mm F - 3/4" F - Ø26,6mm F

**4787** T Ø26,6mm F - Ø26,6mm F - 3/4" F

**4788** T Ø26,6mm F - Ø26,6mm F - Ø26,6mm

**4790** T 3/4" F - Ø26,6mm - 3/4" F

**4793** Angle connection Ø26,6mm F-3/4"

**420104** Threaded cap 1/2"

**4800** Reduction 3/4" M - 1/4 F

**420803N** Nut 3/4" F for out 22mm

**420802** Gasket 3/4"



**4301**  
Flex head Ø22mm for square pipe



**4301R**  
Rigid head Ø22mm for square pipe



**4361FO**  
Pipe connector extension PVC 22x22mm



**4363Q**  
Extension fitting for PVC pipe 28x28mm



**4369**  
Square pipe head with sealing gasket, outlet Ø22mm



**9307**  
Header for square pipe Ø10mm



**43902G**  
Head Ø20mm double gasket for 19x24.5mm square pipe



**4394**  
Joint for square pipe with seal



**43912G**  
End cap Ø10mm double gasket for square pipe 9x12mm



**4725**  
Header for square pipe Ø26.6 mm for connection to pressure regulator



**4368LT**  
S.P. joint 22x22 line cleaning control



**4365** Elastic joint for square pipe L:10cm  
**4367** Elastic joint for square pipe L:12cm



**4368** Coupling for external square pipe with seal L:8cm  
**4368L** L:14cm



**4317**  
Corner header for square pipe Ø22mm



**4368 A**  
Rigid corner joint square pipe 22x22cm





# EGG AND MANURE CONVEYOR BELTS

Our egg conveyor belts are carefully designed to ensure the safe and gentle transport of eggs of all sizes. Made of materials that minimise the risk of damage, they ensure that the eggs reach their final destination intact.

For the efficient transport of eggs, we offer robust and reliable conveyor belts. Our range includes belts designed to handle high volumes of chicken manure cleanly and efficiently. Durable materials and clever design ensure that the manure is transported without spillage, helping to keep the environment clean and hygienic.





## ACCESSORIES FOR BATTERY MANUFACTURERS



**9416**  
Oetiker-type clamp  
pliers



**9411 | 9410**  
Staple pliers  $\varnothing 4\text{mm}$  |  
 $\varnothing 6\text{mm}$



**4590 M** Staple CL 23-  
23,5mm for pneumatic  
stapler  
**9590 M** CL 12-16,5mm



**9412 | 9413**  
Galvanised staple  
 $\varnothing 4\text{mm}$  L:5mm  
|  $\varnothing 6\text{mm}$  L:7mm



**4395 2000**  
R-shaped hand pro-  
tection profile L=2mt



**9335**  
Plastic-coated cable  
 $\varnothing 5,2\text{mm}$  970kg app



**9338**  
Plastic-coated cable  
 $\varnothing 7,8\text{mm}$  2600kg app



**4738**  
Galvanised spring fixing  
 $\varnothing 1.5\text{ mm}$  square pipe



**9660** Spiral spring 21 L=60mm  
**9661** Spiral spring 28 L=72mm  
**9662** Spiral spring 36 L=84mm  
**9663** Spiral spring 56 L=110mm



**OFTCN 0001**  
Air pipe joint



**OFTCN 000S**  
Air pipe cap



**ZUTU0001SEMEC**  
Air pipe joint



**ZUTU000TEMEC**  
Air pipe cap



**ZUTU54..EUMEC**  
Air pipe



**ZUTU0002EMEC**  
Air pipe connection



**9607**  
PVC profile for cages



**9607T**  
Cap for profile 9607



**9607G**  
Profile joint 9607



## BELTS FOR COLLECTING AND CONVEYING EGGS

### Uova



**Perforated PP belt ø20mm**  
 WIDTH From 7 cm to 500 cm  
 THICKNESS from 1 mm to 2.4 mm

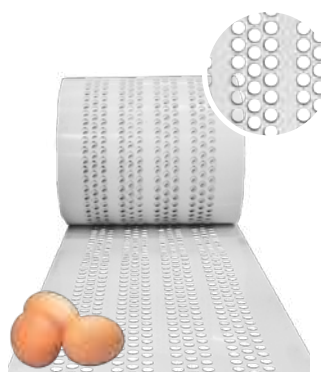

**268006PP**  
 Polypropylene woven tape  
 WIDTH from 9 cm to 11 cm

## ULTRASONIC WELDER



**040180**

Ultrasonic welder 250/400 watt for PP strip art. no. 268106

**04018001**

Ultrasonic welder 1.2 and 1.6 - on request also for egg conveyor belt

**04018002**

Handle

## BELTS FOR COLLECTING AND CONVEYING MANURE

### Pollina



**2681...**  
**MANURE COLLECTION BELT**

Smooth polypropylene belt  
 WIDTH 100 mm to 2500 mm | THICKNESS 0.5 to 2.4 mm  
 LENGTH max. 1000 m\* x 1 mm thickness \* length is variable depending on width dimension.

Available in various thicknesses



**2691...**  
**MANURE DRYING BELT**

Perforated polypropylene belt v type MDS  
 WIDTH max. 2000 mm THICKNESS 1.2 mm to 2.4 mm

## NEBULISATION SYSTEMS

### Kit



**53200CA**  
Nebulizer attachment kit  
ø12mm thread 1/8"

**53200C**  
Nebulizer attachment kit  
ø 20mm thread 1/8"



**5320A**  
Nebulizer U=0.4 T=G B.P. (orange)



**5320V**  
Nebulizer U=0.5 T=G A.P. (green)



**5320G**  
Nebulizer U=0.3 T=G M-B.P. (yellow)

### Kit



**53300CA**  
Nebulizer attachment kit  
ø12mm thread 3/16"

**53300C**  
Nebulizer attachment kit  
ø20mm thread 3/16"



**INOX NEBULISER**  
Nozzle available in different diameters (0.30 and 0.40) thread 3/16"

**53500I**  
Medium pressure nebuliser (ø 0,4mm)

**53600I**  
High pressure nebuliser (ø 0,3mm)

**53700I**  
Nebulizer nozzle assembly ø 0.2 mm red

### Capacity table



**Art. 5320 G**

Nozzle colour: YELLOW  
ø 0,3mm



**Art. 5320 A**

Nozzle colour: ORANGE  
ø 0,4mm



**Art. 5320 V**

Nozzle colour: GREEN  
ø 0,5mm

Pressure	Water flow rate in litres/hour	Water flow rate in litres/hour	Water flow rate in litres/hour
5bar (70psi)	6,5	6,9	not tested
10bar (140psi)	8,46	8,95	10,50
20bar (280psi)	10,44	11,4	14,40
30bar (420psi)	11,64	13,56	16,32
40bar (560psi)	13,36	14,66	18,00
50bar (700psi)	14,1	15,56	21,18



## Low pressure



**5370**  
Low pressure nebuliser  
type BR fitted

Codes	Descriptions	Material
53701	Attachment kit	Polypropylene
53705	Filter D14.8-50micron	Nylon
53001	Threaded Nut M16.5x1.3	Acetal Resin
53706	Nebuliser disc kit	Acetal Resin
5371	Anti-Drip Kit	Polypropylene

## Pipes and Fittings



**5110**

PVC round pipe for low  
pressure ø20mm - øint 17mm

**5114**

Tubo tondo PVC per alta  
pressione ø20mm - øint 13  
mm



**530010T**

T- connector for nebulisation  
system øint 20mm



**530010A**

Angle connection for  
nebulisation system øint  
20mm



**530010M**

Nebulisation system  
connection øint 20mm



**53007**

Pressure gauge ø63 for press.  
0-12 att.rad.



**53009**

2HP three-phase pump  
50HZ

## SLATS AND ACCESSORIES

## Pigs

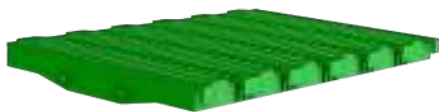
**6500060040**

Slat for pigs and piglets 60x40 | height 5 cm | capacity 110 kg

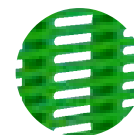
**6600060040**

Sow slat 60x40 | height 8 cm | capacity 250 kg

## Pigs

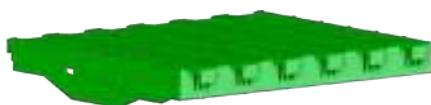
**66000**

Sow slat 60x40 | height 8 cm | capacity 250 kg



## Pigs

**6200** Pig feeder

620001	Pig dosing top	Polypropylene
620002	Damper	Polypropylene
620003	Dispensing sliding cone	Polypropylene
620004	Lower cone	Polypropylene
620005	Lid for dosing tube	Polypropylene
620006	Dosing ring	Polypropylene
620007	Ring D11-46-6-74gr.	
620008	Dosing rod	
620009	Dosing tube L-400	
6200010	Dosing kit for pigs	Acetal Resin, ABS
6200011	Dosing kit for pigs	Acetal Resin, ABS
6200012	Dosing kit for pigs	Acetal Resin, ABS
6200013	Swine caulker	
6200014	Swine dosing rope rosette	

## Poultry

**4400 S**

Poultry slat 90x60 cm

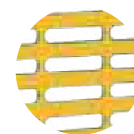

## Poultry

**4400 C | 4400 L**

Poultry slat 60x100 cm | 60x120 cm





# SLATS



## pigs, piglets and sows



**Polypropylene** with  
UV protection



**Resistance**  
250 kg





A group of chickens, including several white hens and a few brown and black roosters, are gathered in a grassy field under a bright, hazy sky. The scene is bathed in warm, golden light, suggesting late afternoon or early morning. The chickens are positioned in the foreground and middle ground, with some looking towards the camera and others looking away. The background is a soft-focus landscape of green fields and distant trees.

# FAMILY SECTION

Section dedicated to the family of poultry feeders and drinkers, designed to ensure the well-being and productivity of your animals. Discover our wide range of products designed to meet the specific needs of poultry families, offering practical, hygienic and durable solutions.



## CIRCULAR DRINKERS



**4018**  
10 lt plastic siphon  
drinker



**4014**  
1.5 lt plastic siphon  
drinker



**4012**  
3 lt plastic siphon  
drinker



**4015**  
Automatic circular  
drinker for chickens



**4013**  
Plastic siphon drinker  
5 lt

## FEEDERS FOR POULTRY FARMING



**8250**  
18 kg plastic hopper  
feeder for chickens



**8251**  
18 kg plastic hopper  
feeder for chicks



**8254**  
Lid for hopper feeder



**8252**  
10 kg plastic hopper  
feeder for chickens



**8253**  
10 kg plastic hopper  
feeder for chicks



**4501**  
Feeder plate chicks  
ø40 cm



**8357**  
Winner plastic hopper  
feeder 12kg approx. for  
chicks

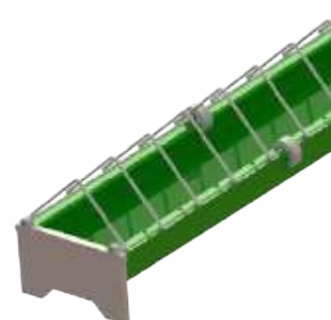

**8349 | 8350 | 8351 | 8346 | 8347**  
Feeder plate for chicks and pullets  
50cm | 40cm | 30cm | 100cm | 75cm





## DRINKERS FOR CONICULTURE

### Rabbits



**9002** Drip drinker with stainless steel elastic connection, connectable with  $\varnothing 9$ mm flex pipe art. 9101. The tank should be positioned 20 cm higher. The ideal position is 25 cm from the bottom of the cage.

**9002MF** As art. 9002 with T-joint MF

4001	Drinkers Kit 4001
9999	Pipette x 9002
900201	Stainless steel connection
9301	Connection to T DIA 10

### Rabbits



**9003** Drip drinker with stainless steel screw connection and T-joint

**9003MF** As art. 9003 but with MF T-joint

### Rabbits



**9008** Three-piece plastic bottle drinker

### Rabbits



**9015** Metal drinker

### Rabbits



**9005** Plastic bottle holder drinker

900501	Bottle-holder cup
900502	Wedge
900503	Bottle-holder ring

### Rabbits



**4510** Multipurpose constant level drinker

**451001** Rubber gasket

## SLATS FOR CONICULTURE

### Slat

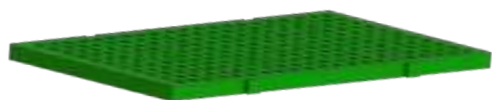

**RO 500127**

Moulded slat for rabbit L: 27 cm

**RO 500251**

Moulded slat for rabbit L: 51 cm

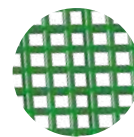

### Slat



**960924**

Moulded slat for rabbit 49,5 cm x 24,75 cm

**960914**

Moulded slat for rabbit 49,5 cm x 14,5 cm

**960935**

Moulded slat for rabbit 49,5 cm x 35 cm

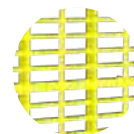

### Rug



**4500390500**

Nesting mat 39x50 cm

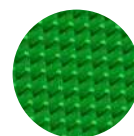

**8180**

Gas breeder | infrared | 2,500cal/h for 500 animals approx. | with safety valve

960924

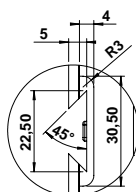
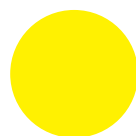

DETTAGLIO D  
SCALA 1 : 1

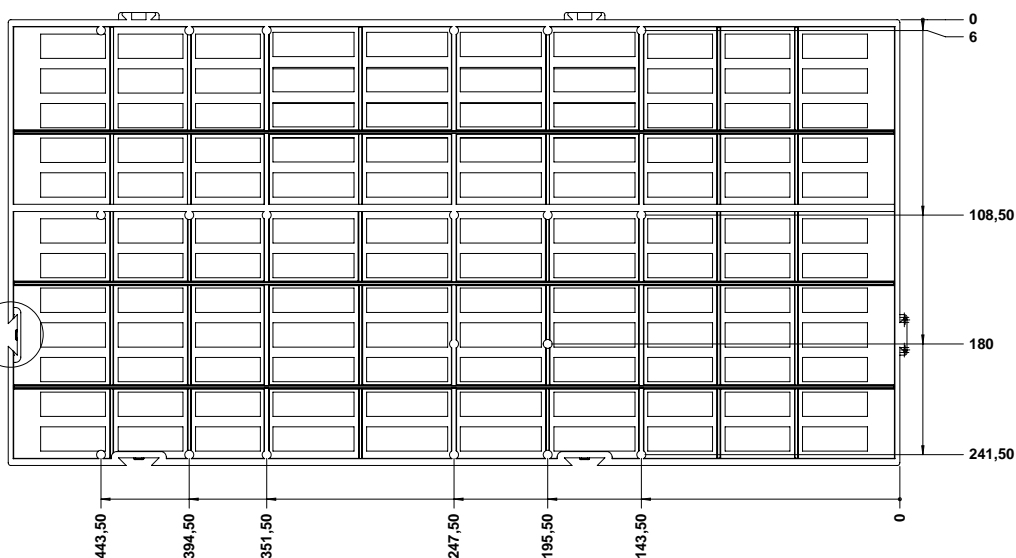

## FEEDERS AND ACCESSORIES FOR RABBIT FARMING



**9503 | 950202**  
Plastic feeder with non-rotting edges 1.8kg app. | lid



**965001 | 965002**  
Rabbits' nest 37x25x15cm | Rabbits' nest bottom cover 35,4x23,7cm



**965001 BR/BB/BG | 965002 B**  
Recessed nest for rabbits 39,5x24,5cm | Nest mat 31x16,5



**960350** Seam for slat L=50cm  
**960360** L=60cm | **960373** L=73cm  
**960398** L=98cm | **9603** L=100cm



**9601**  
Plastic profile for rabbits



**9653**  
Long-barrel gas burner for disinfection and disinfection of cages and poultry house



**9651**  
Handy 19x12cm plastic card holders for easy writing, suitable for all types of nurseries



**9652**  
Diazin: ideal for animal and livestock welfare



**9655**  
Rabbit scales capacity: 10kg





## DRINKERS FOR HOBBY BREEDING

### Laying hens



**4028** A drinker for laying hens with elastic coupling, to be applied to drinker 4005 with tray 4618, perfect for small systems, avoids the use of square pipes. To be attached to the cage by means of the stainless steel elastic connection and the special T-piece.

Max 15 animals

### Laying hens



**4038** Drinker with stainless steel screw connection, as art. 4028

### Chicks



**4029** Chick drinker with elastic connection, as art. 4028 but equipped with automatic tray + T-connector. Also ideal for day-old chicks and boilers.

Max. 20 animals

### Rabbits



**4039** Chick drinker with elastic connection, as art. 4038 but equipped with automatic tray + T-connector. Also ideal for day-old chicks and boilers.

Max. 20 animals

### Ornithology



**4505** Automatic drinkers for ornithology

**4504** Automatic drinkers for quail

450501	Upper part with nozzle
450502	Cup for ornithology
450503	Sheet metal counterweight
450504	Stick-stop tube

### Hens



**4030**  
28 litre plastic siphon drinker

403001	Cap gasket
403002	Plastic cap
403004	Seal ring for closure
403006	Pond holder
403007	Upper ring
403008	Back case

## Ø10MM FITTINGS AND ACCESSORIES



**9301**  
T-connector ø10mm



**9302**  
Cross connector ø10mm



**9303**  
Angle connection ø10mm M/F



**9304**  
Cup ø9mm



**9305**  
Brass tap with hose connector ø10mm



**9308**  
Joint ø10mm



**9311**  
Reduction in plastic ø22-10mm



**9313**  
Angular joint ø10mm



**9314**  
Plastic hose outlet ø10mm



**9333**  
1/8" conical threaded cap



**9316**  
T-connector ø10mm M/F



**9101**  
Black flex pipe ø9x12mm



**264519**  
Minifilter with ø10mm plug



**9309**  
Water inlet for square PVC pipe



**4307** Anti-rotation support  
**4332** Corner extension  
**4304** extension 5,5cm  
**4305** extension 12cm  
**4308** extension 9cm



**264801 | 264901**  
Plastic beak covers for heavy and light pheasants



**264524 | 264525**  
Metal pheasant coverlet | Metal pheasant ring



**264802 | 264902**  
Plastic ring for heavy and light pheasants



**264498 | 264501**  
Glasses for laying hens and pheasants



**264518**  
Arrow for spectacles and for beak covers

## YOUR INCUBATOR ALWAYS SMARTER!



Wi-Fi  
connection



Adjust values from  
your smartphone



Stores hatching  
data



### 2500D

Digital incubator capacity 25 eggs approx.

### 5000D

Digital incubator capacity 50 eggs approx.



### 5005

Automatic egg turner

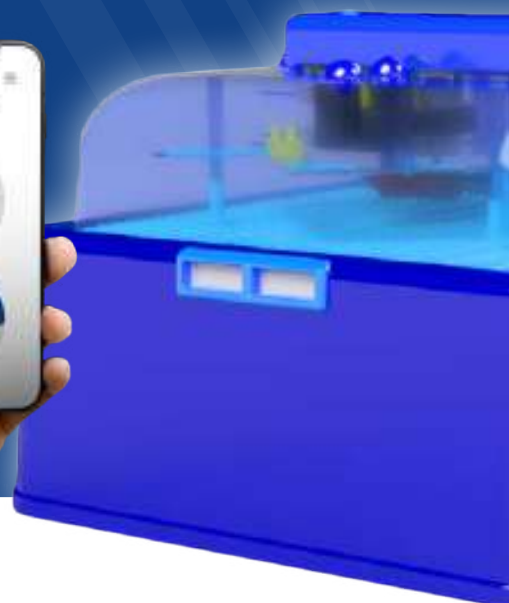

### 6060

Constant level plastic drinking trough for dogs, horses and other animals. The highly resistant resin makes it suitable also for large animals



### 264601026

Chicken plucker 220V - 50Hz - 0.5HP - 24 fingers Before use, immerse the animal in hot water (55°C)

Productivity: 80 chickens/hour, single-phase motor



### 26460125

Plucking fingers





Use a **QR code reader** on your device to access our website.

Via Volta 4, Monvalle (VA) 21020, Italy | [info@cortizotecnici.com](mailto:info@cortizotecnici.com)  
+39 0332 799 985

[www.cortizotecnici.it](http://www.cortizotecnici.it)

YouTube Instagram Facebook LinkedIn



# PRODUCT CATALOGUE

Articles and Accessories for Breeding



Via Volta 4, Monvalle (VA) 21020, Italy  
info@cortizootecnici.com | +39 0332 799 985

[www.cortizootecnici.it](http://www.cortizootecnici.it)

📺 📷 📱 📺

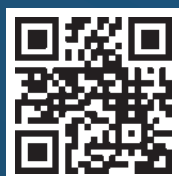

Use a **QR code reader** on your device to access our website.